

09.00

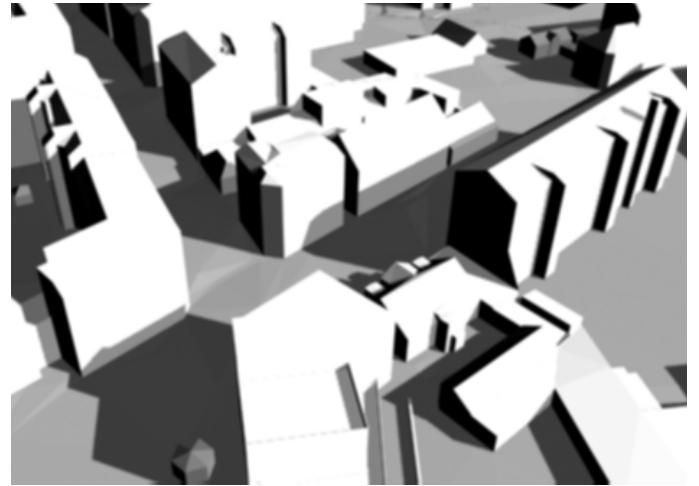

Kl. 9.00 når skyggen op på det underste af stueetagens facade på Øresundsvej nr. 15.

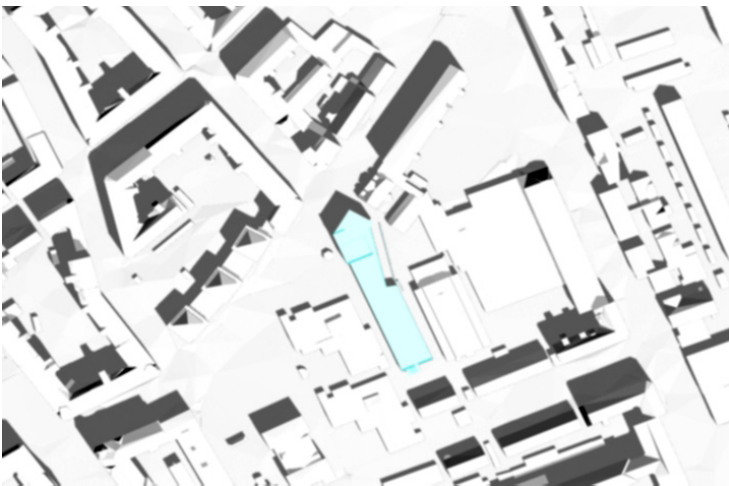

12.00

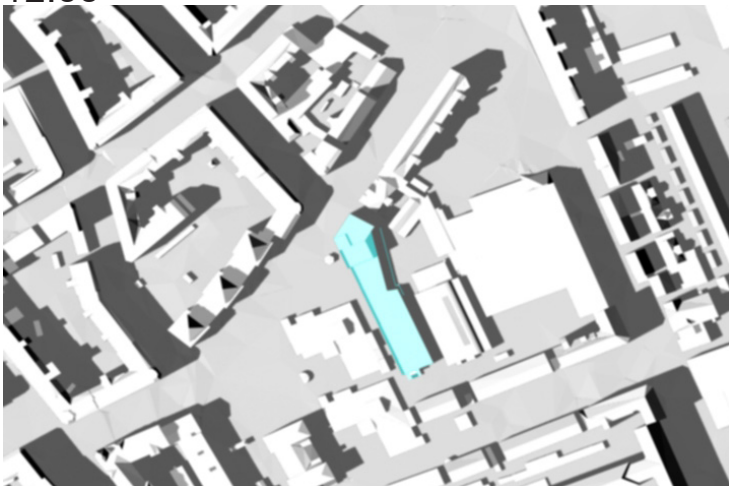

16.00

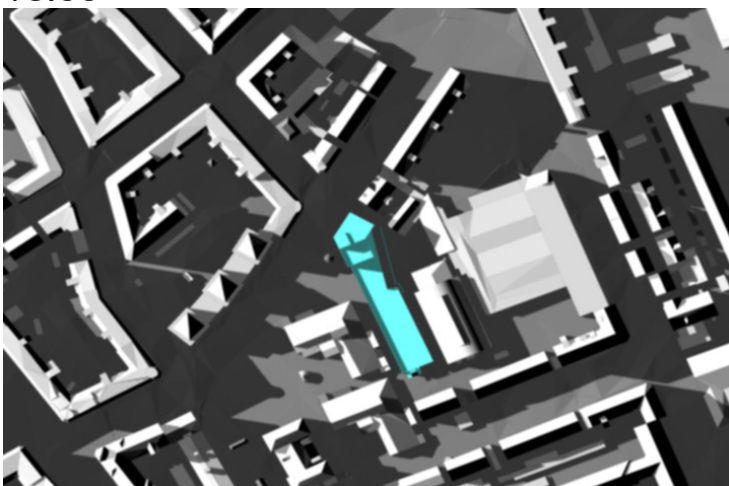

19.00

21. SEPTEMBER

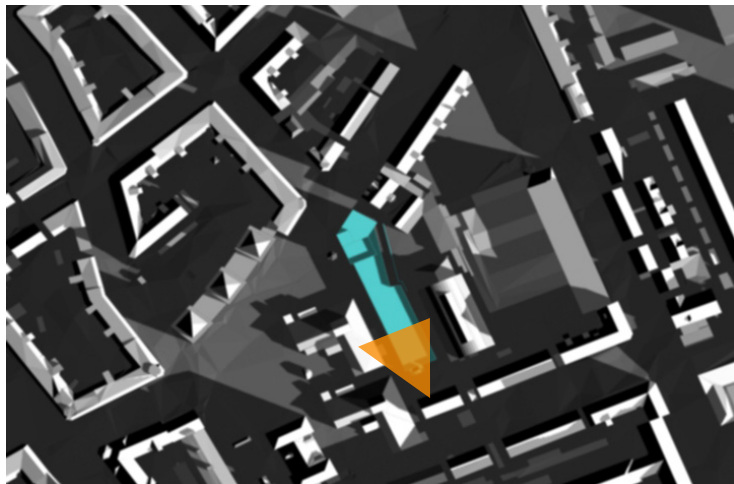

09.00

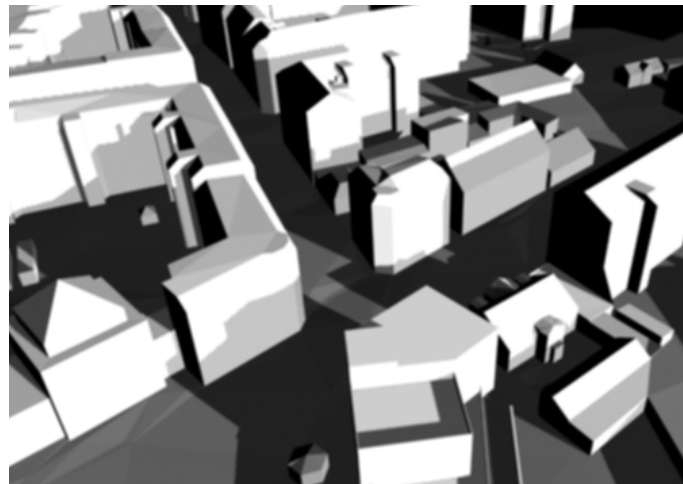

Kl. 9.00 når skyggen halvejs op på facaden af Øresundsvej nr. 15.

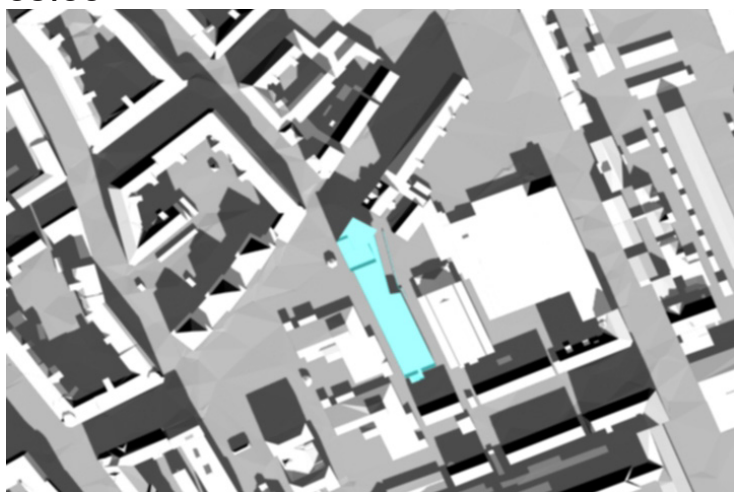

12.00

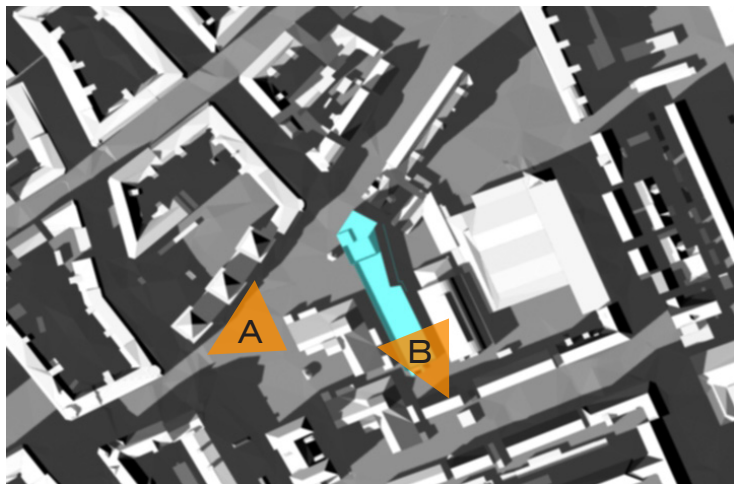

16.00

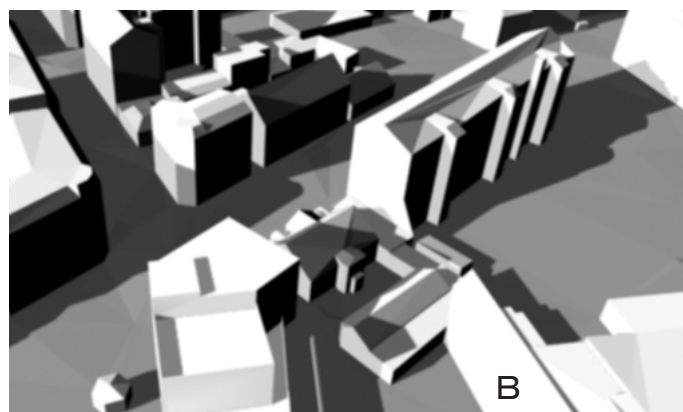
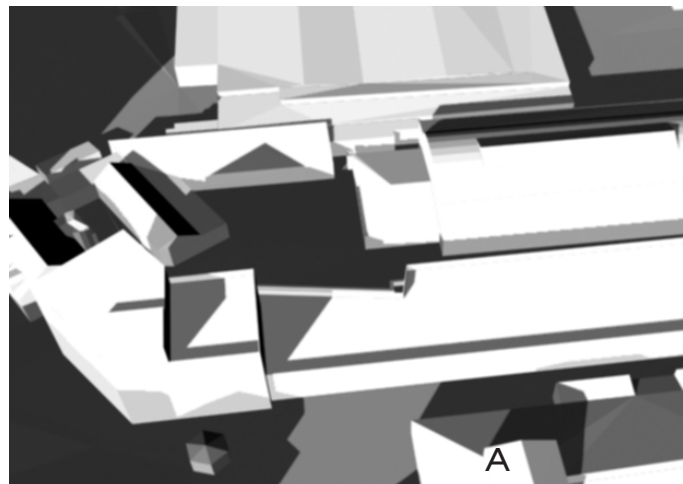

21. DECEMBER

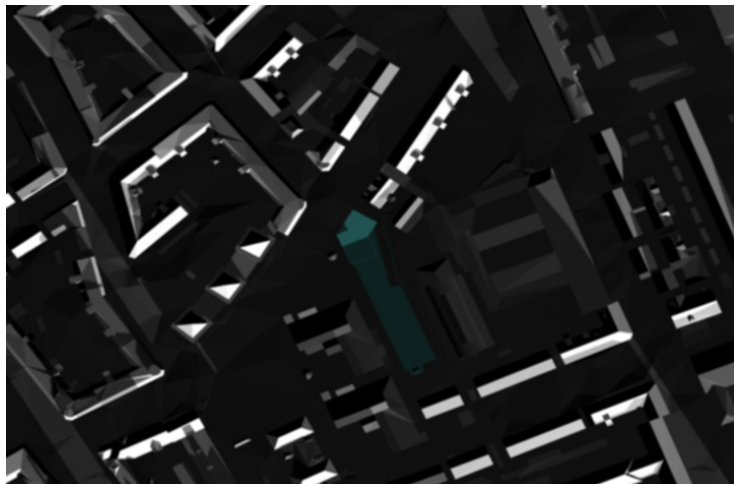

10.00

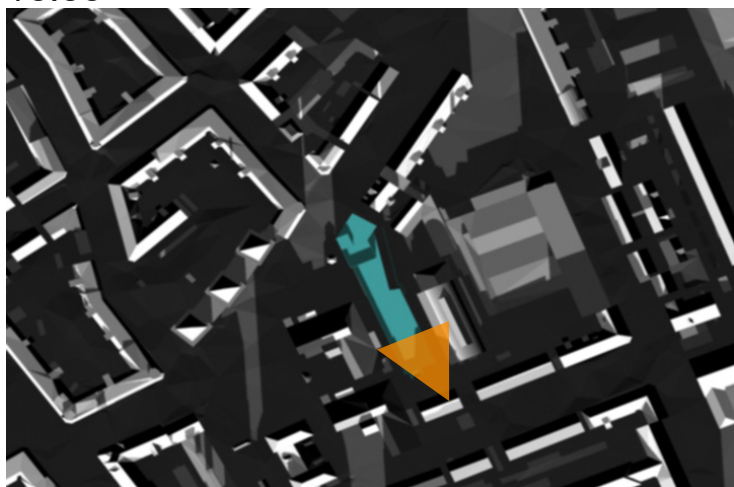

12.00

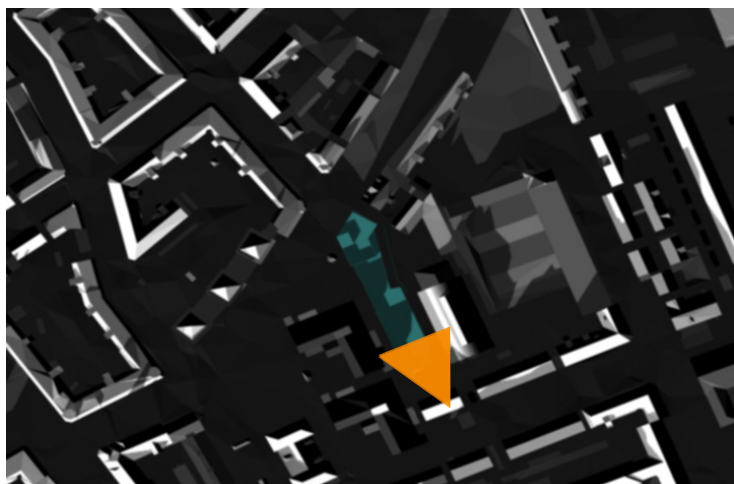

14.00

Den 21. december, er årets korteste og mørkeste dag. Tidspunkterne er derfor 10, 12 og 14.

Kl. 12.00 dækker skyggen det meste af facaden på øresundsvej nr. 17.

